

LAT-CON 127, Male, Height 9.90 mm, Pitch 1.27 mm

Recommended P.C.B Layout (Top Side) (PCB BOARD TOLERANCE ±0.05)

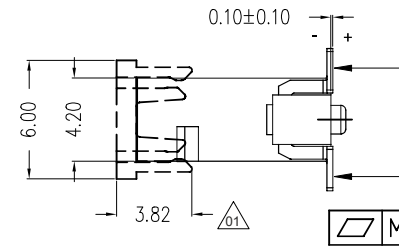
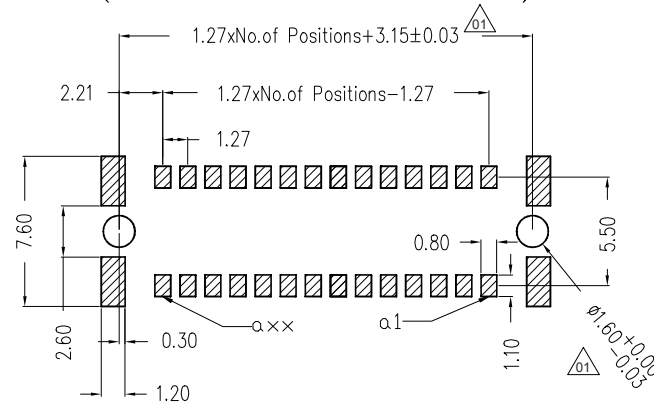

NOTES:

Rated Current: 1.2A at 20°C max. Δ
 Contact Resistance: 25m Ω Max. Δ
 Withstand Voltage: 500V
 Insulation Resistance: 10000M Ω Min.
 Operation Temperature: -55°C to +125°C

Contact Material: Phosphor Bronze
 Contact Plating: Sn and Au over Ni
 Tail Material: Phosphor Bronze
 Tail Plating: Sn over Ni
 Main Body Material: LCP
 CAP Material: LCP

Pancon P/N	Pin
033H012-167U	12
033H016-167U	16
033H020-167U	20
033H026-167U	26
033H032-167U	32
033H040-167U	40
033H050-167U	50
033H068-167U	68
033H080-167U	80

PIN	M
10~40PIN	0.12
42~100PIN	0.15

HOUSING PIN	DIM A
10-24	7.00
26-100	16.00

REV	DATE	NOTE	NAME
02	02.08.2018	modified	vav
01	12.07.2018	modified	vav
00	27.06.2017	issued	vav

