

# LAT-CON 127, Male, Height 6.70mm, Pitch 1.27mm

NOTES:  
 Rated Current: 1.2A at 20°C max.  $\Delta$   
 Contact Resistance: 25m $\Omega$  Max.  $\Delta$   
 Withstand Voltage: 500V  
 Insulation Resistance: 10000M $\Omega$  Min.  
 Operation Temperature: -55°C to +125°C

Contact Material: Phosphor Bronze  
 Contact Plating: Sn and Au over Ni  
 Tail Material: Phosphor Bronze  
 Tail Plating: Sn over Ni  
 Main Body Material: LCP  
 CAP Material: LCP

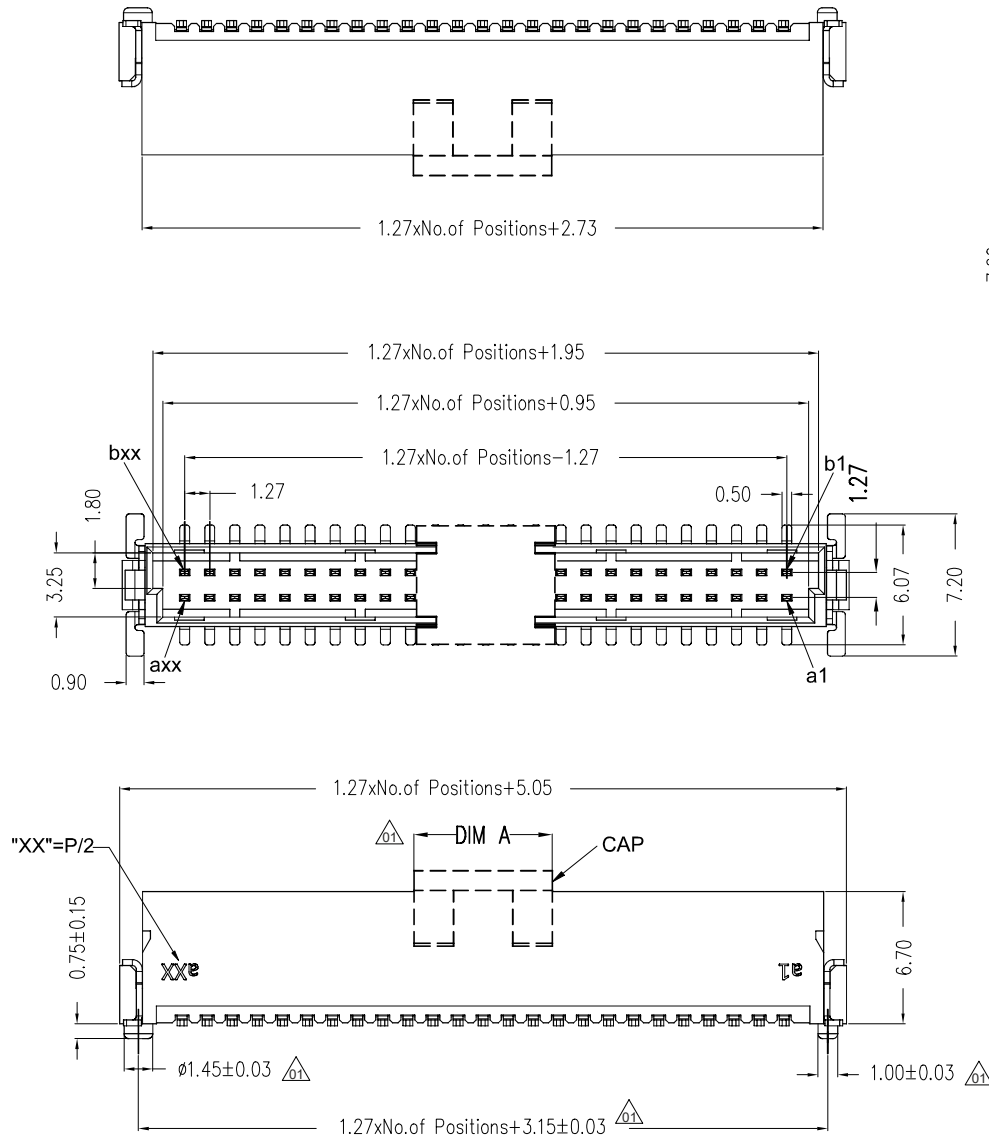

## Recommended P.C.B Layout (Top Side) (PCB BOARD TOLERANCE $\pm 0.05$ )

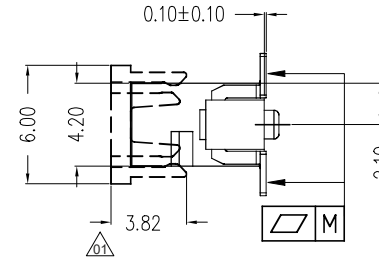
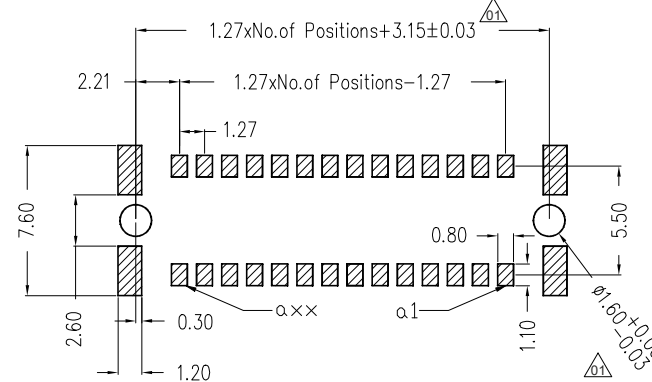

PIN	M
10~40PIN	0.12
42~100PIN	0.15

HOUSING PIN	DIM A
10-24	7.00
26-100	16.00

Pancon P/N	Pin
033L012-167U	12
033L016-167U	16
033L020-167U	20
033L026-167U	26
033L032-167U	32
033L040-167U	40
033L050-167U	50
033L068-167U	68
033L080-167U	80

REV	DATE	NOTE	NAME
02	02.08.2018	modified	vav
01	12.07.2018	modified	vav
00	12.01.2018	issued	vav