

2.00mm Socket, Dual Row, 180°, 4mm height

NOTES:

- Current Rating: 2.0AMP
- Voltage Rating: 500V AC/DC
- Contact Resistance: 20mΩ Max
- Insulation Resistance: 1000MΩ Min
- Operation Temperature: -40°C to +105°C
- Contact Material: Phosphor Bronze
- Contact plating: Au or Sn over 50 μ" Ni
- Insulator Material: PA6T+30%G. F UL94V-0

Recommended P.C.B Layout (Top Side)
(PCB BOARD TOLERANCE ±0.05)

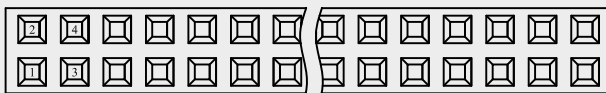
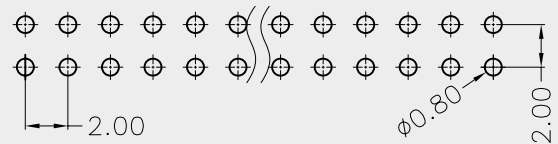

TYPE 1 W/O BUMP

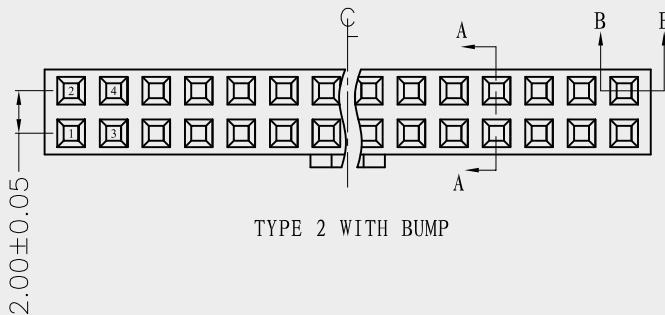

TYPE 2 WITH BUMP

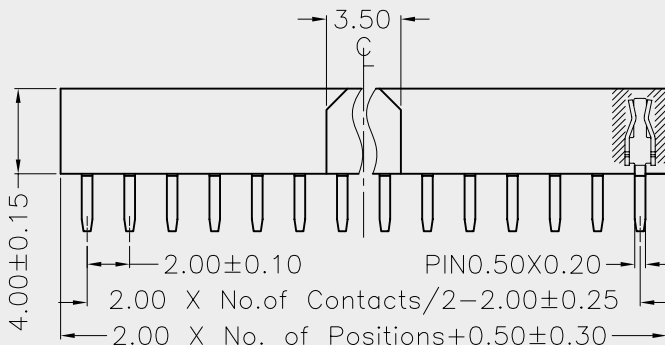

SECTION B-B

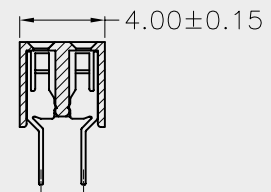

TYPE 1 W/O BUMP

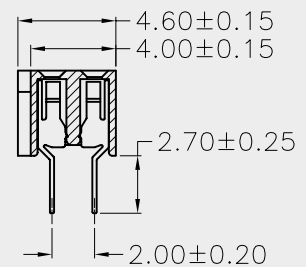

TYPE 2 WITH BUMP

SECTION A-A

1	120207	Logo changed	rok
REV	DATE	NOTE	NAME